

	GAS	I12G Ex d IIC T4 ÷ T5	Gb	IP66	Zone 1 - Zone 21 - Zone 2 - Zone 22	
	DUST	I12D Ex tb IIIC T95°C ÷ T130°C	Db	IP66	❄️-20°C ÷ ☀️+40°C	❄️-20°C ÷ ☀️+80°C

Caratteristiche: Interruttori semirotaativi a cammes con formato frontale

Materiale : Lega leggera

A richiesta: Viti di acciaio inox - guarnizioni al silicone

Features: Cam rotary switches with frontal drive

Material : Light alloy (alluminium)

Optional: Stainless screws - silicon gaskets

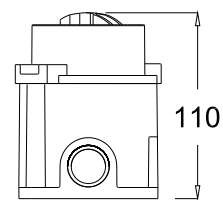
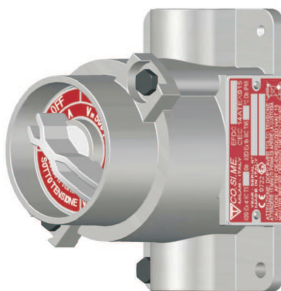

Codice Code	N° Poli Poles N°	Corrente Current
FSPC 210	2	16A
FSPC 310	3	16A
FSPC 410	4	16A

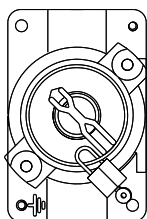

FSPC.. 10 lucchettabile
Aggiungere al codice il suffisso L

Padlocking FSPC..10
Add to code the suffix L

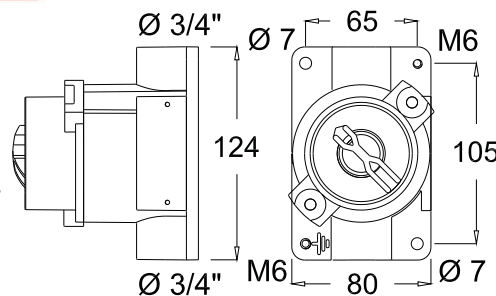

	GAS	I12G Ex d IIC T4 ÷ T5	Gb	IP66	Zone 1 - Zone 21 - Zone 2 - Zone 22	
	DUST	I12D Ex tb IIIC T95°C ÷ T130°C	Db	IP66	❄️-20°C ÷ ☀️+40°C	❄️-20°C ÷ ☀️+80°C

Caratteristiche: Interruttori semirotaativi a cammes con formato frontale

Materiale : Lega leggera

A richiesta: Viti di acciaio inox - guarnizioni al silicone

Features: Cam rotary switches with frontal drive

Material : Light alloy (alluminium)

Optional: Stainless screws - silicon gaskets

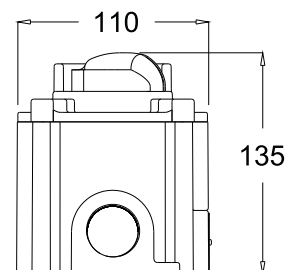

Codice Code	N° Poli Poles N°	Corrente Current
FSPC 325	3	32A
FSPC 425	4	32A
FSPC 625	6	32A
FSPC 825	8	32A

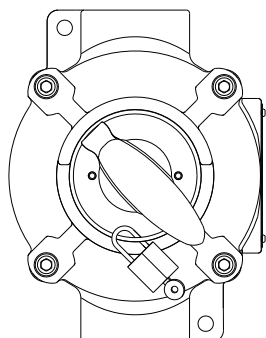

FSPC.. 25 lucchettabile
Aggiungere al codice il suffisso L

Padlocking FSPC..25
Add to code the suffix L

