

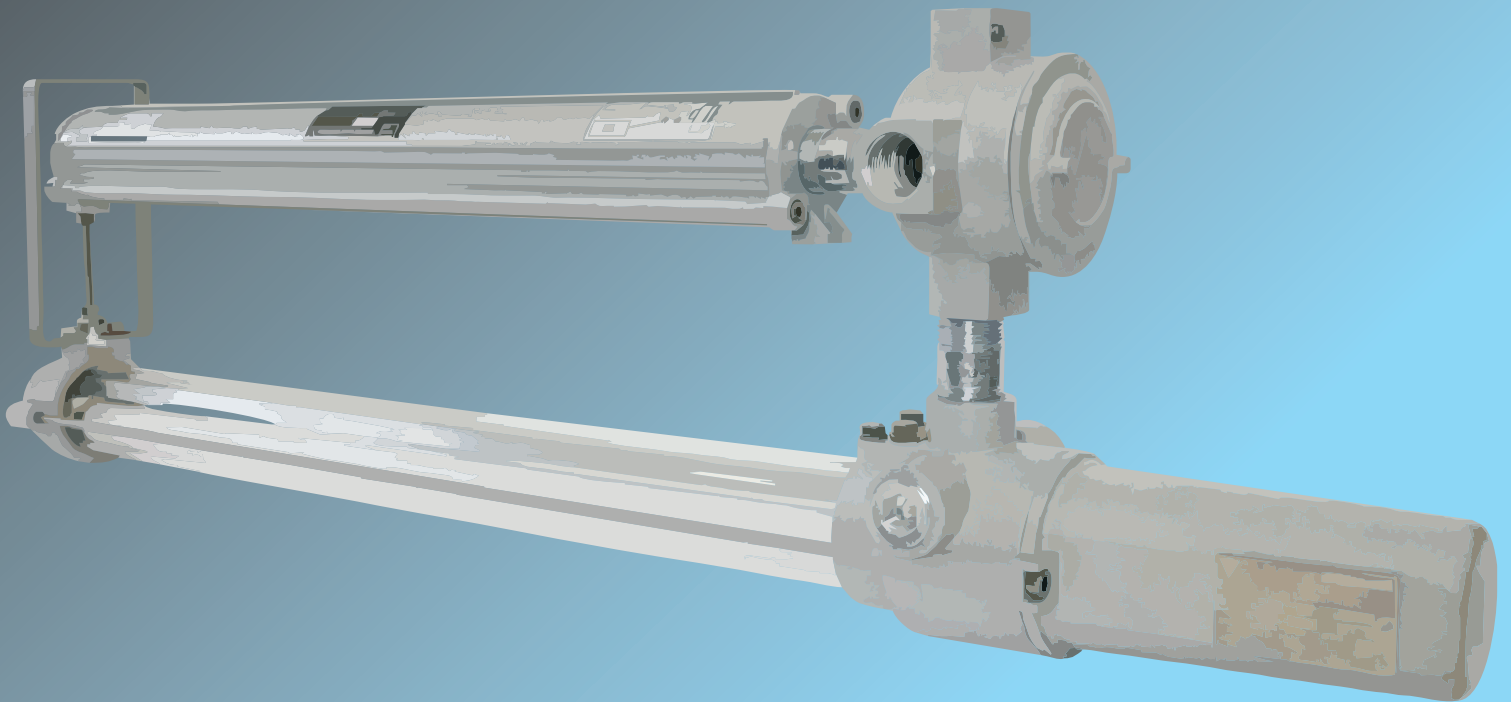

**CO.SI.ME.**  
EQUIPMENT FOR ATEX

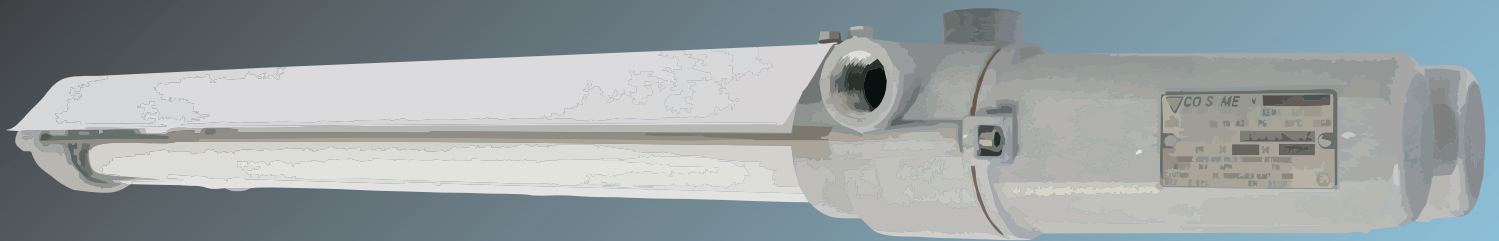



<b>GAS</b>	<b>II2G Ex d IIC T6 ÷ T4</b>	<b>Gb</b>	<b>IP66/67</b>	<b>Zone 1 - Zone 2 Zone 21 - Zone 22</b>
<b>GAS</b>	<b>II2D Ex tb IIIC T80÷T130°C</b>	<b>Db</b>	<b>IP66/67</b>	<b>❄️-20°C ÷ ☀️+40°C      ❄️-20°C + ☀️+60°C</b>

Materiale : Corpo di lega leggera  
 Parte trasparente : Vetro Borosilicato  
 Installazione : Con staffe in acciaio inox  
 Viti :  
 In acciaio inox  
 Guarnizioni : Al silicone  
 Portalampane : Polycarbonato attacco G13 o G5  
 Ingresso : EVF : N° 3 ø3/4" - EVFC : N° 2 ø3/4"

Material : Light alloy body  
 Transparent part : Borosilicate glass  
 Installation : Stainless steel lugs  
 Hardware : Stainless steel  
 Gaskets : Silicon  
 Lampholder : Polycarbonate G13 or G5 caps  
 Cable entry : EVF : N° 3 ø3/4" - EVFC : N° 2 ø3/4"

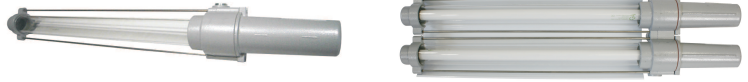

Codice / Code	A	B	C	[W]	weight [kg]
EVF.. 118..	610	205	573	1 x 4+20	
EVF.. 218..	610	205	573	2 x 4+20	
EVF.. 136..	1210	205	1173	1 x 32+54	
EVF.. 236..	1210	205	1173	2 x 32+54	
EVF.. 158..	1510	260	1473	1 x 51+65	
EVF.. 258..	1510	260	1473	2 x 51+65	

Tensione : 230 [Vac] a richiesta [110Vac/dc]  
 24 [Vdc] vedi P8 : EVF con LED  
 Fattore di potenza : >0.9 con reattore elettronico  
 Accessori : tubo fluorescente : suffisso (L)  
 (a richiesta) Riflettore : suffisso (D)  
 Gabbia : suffisso (P)  
 Condensatore : suffisso (C)  
 Voltage : 230 [Vac] on demand [110Vac/dc]  
 24 [Vac] see P8 : EVF with LED

Power factor : >0.9 with electronic ballast  
 Accessories : fluorescent tube : suffix (L)  
 (on demand) Reflector : suffix (D)  
 Guard : suffix (P)  
 Capacitor : suffix (C)

EVF 1.. EVFC 1..	EVFC 2..	EVF 2..
	<b>Conduttori sigillati</b> <b>Cemented conductors</b>	<b>Conduttori sigillati</b> <b>Cemented conductors</b>
<b>N° 3 imbocchi Ø 3/4"</b> <b>N° 3 entries Ø 3/4"</b>	<b>N° 2 imbocchi Ø 3/4"</b> <b>N° 2 entries Ø 3/4"</b>	<b>N° 2 imbocchi Ø 3/4"</b> <b>N° 2 entries Ø 3/4"</b>

**Reattore induttivo EVF.. ..R - Elettronico EVF.. ..X**  
**Inductive ballast EVF.. ..R - Elettronico EVF.. ..X**

**Reattore sigillato a richiesta EVF.. ..W**  
**On demand sealed ballast EVF.. ..W**

**Coperchi di chiusura**  
**Blind cover**

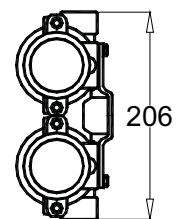
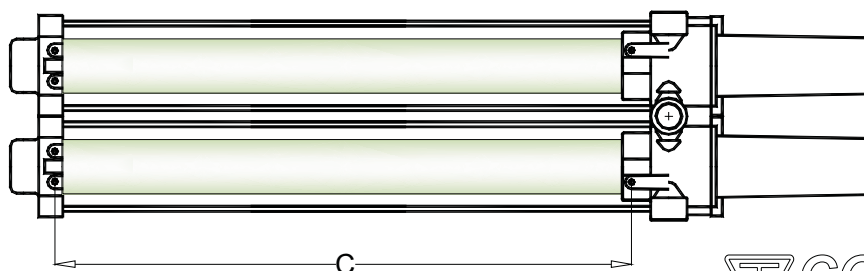
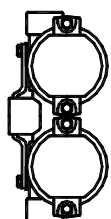
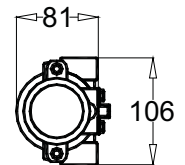
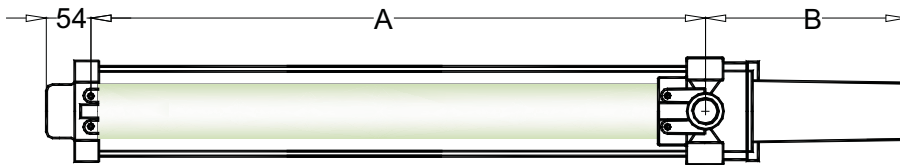
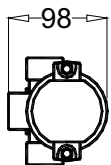



GAS	II2G Ex d IIC T6 ÷ T4	Gb	IP66/67	Zone 1 - Zone 2 Zone 21 - Zone 22
GAS	II2D Ex tb IIIC T80÷T130°C	Db	IP66/67	❄️-20°C ÷ ☀️+40°C    ❄️-20°C ÷ ☀️+60°C

**Reattore induttivo**  
*Inductive ballast*

Codice / Code	A	B	C		[W]	weight [kg]
EVF.. 118R	610	205	573	G13	1x16+18	
EVF.. 218R	610	205	573	G13	2x16+18	
EVF.. 136R	1210	205	1173	G13	1x32+36	
EVF.. 236R	1210	205	1173	G13	2x32+32	
EVF.. 158R	1510	260	1473	G13	1x51+58	
EVF.. 258R	1510	260	1473	G13	2x51+58	

**Reattore elettronico**  
*Electronic ballast*

Codice / Code	A	B	C		[W]	weight [kg]
EVF.. 118X	610	205	573	G13	1x16+18	
EVF.. 218XX	610	205	573	G13	2x16+18	
EVF.. 136X	1210	205	1173	G13	1x32+36	
EVF.. 236XX	1210	205	1173	G13	2x32+32	
EVF.. 158X	1510	260	1473	G13	1x51+58	
EVF.. 258XX	1510	260	1473	G13	2x51+58	

**Reattore elettronico sigillato**  
*Sealed electronic ballast*

Codice / Code	A	B	C		[W]	weight [kg]
EVF.. 118W	610	205	573	-	1x16+18	
EVF.. 218W	610	205	573	-	2x16+18	
EVF.. 136W	1210	205	1173	-	1x32+36	
EVF.. 236W	1210	205	1173	-	2x32+32	
EVF.. 158W	1510	260	1473	-	1x51+58	
EVF.. 258W	1510	260	1473	-	2x51+58	

**Reattore elettronico**  
*Electronic ballast*

Codice / Code	A	B	C		[W]	weight [kg]
EVF.. 116X	610	420	573	G5	1x16	
EVF.. 216XX	610	420	573	G5	2x16	
EVF.. 128X	1210	420	1173	G5	1x28+54	
EVF.. 228XX	1210	420	1173	G5	2x28+54	
EVF.. 135X	1510	420	1473	G5	1x35+49	
EVF.. 235XX	1510	420	1473	G5	2x35+49	

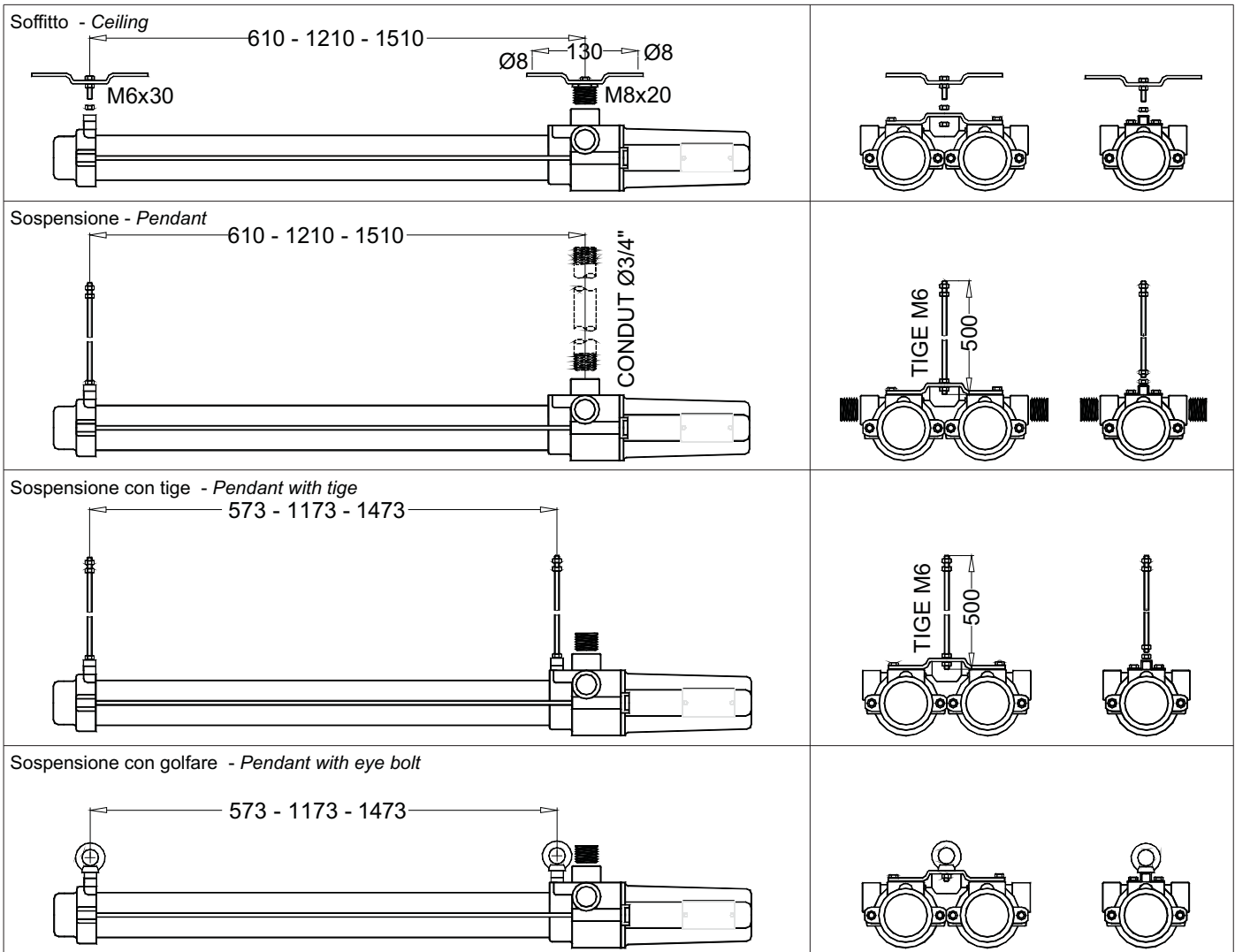

	GAS	II2G Ex d IIC T6 ÷ T4	Gb	IP66/67	Zone 1 - Zone 2 Zone 21 - Zone 22
	GAS	II2D Ex tb IIIC T80÷T130°C	Db	IP66/67	❄️-20°C ÷ ☀️+40°C    ❄️-20°C + ☀️+60°C

Parete 45° - Wall 45°

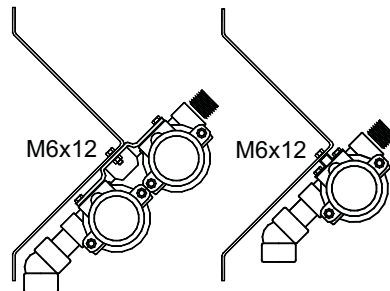
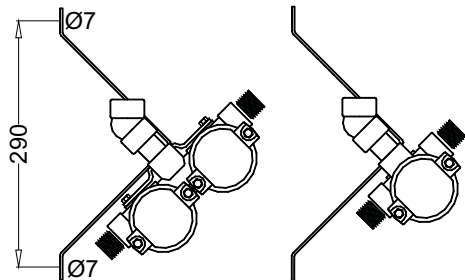

Palina/pressacavo - Pole/cable gland

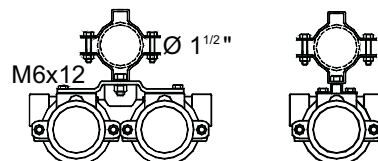
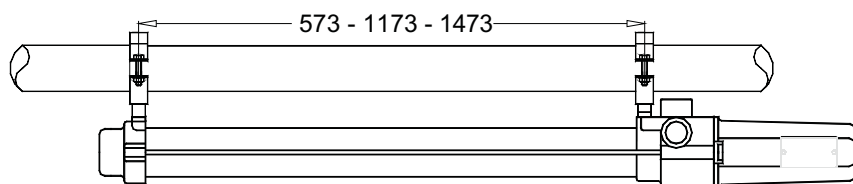

Palina/conduit - Pole/conduit

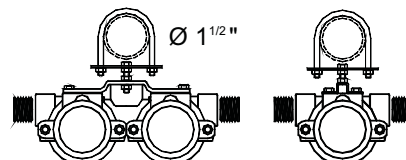
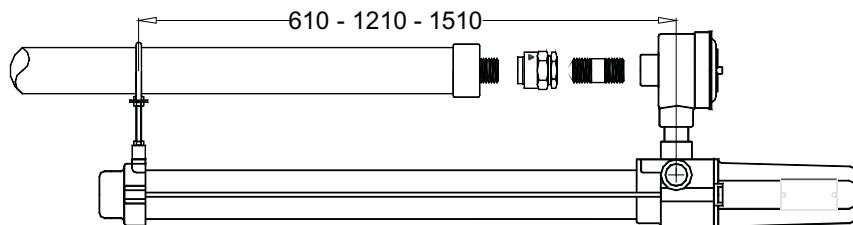

Paline - Poles





<b>GAS</b>	<b>II2G Ex d IIC T6 ÷ T4</b>	<b>Gb</b>	<b>IP66/67</b>	<b>Zone 1 - Zone 2 Zone 21 - Zone 22</b>
<b>GAS</b>	<b>II2D Ex tb IIIC T80+T130°C</b>	<b>Db</b>	<b>IP66/67</b>	<b>❄️-20°C ÷ ☀️+40°C    ❄️-20°C ÷ ☀️+60°C</b>

Materiale : Corpo di lega leggera  
 Parte trasparente : Vetro Borosilicato  
 Installazione : Con staffe in acciaio inox  
 Viti : In acciaio inox  
 Guarnizioni : Al silicone  
 Portalampade : Policarbonato attacco G13 o G5  
 Ingresso : EVF : N° 3 ø3/4" - EVFC : N° 2 ø3/4"

Material : Light alloy body  
 Transparent part : Borosilicate glass  
 Installation : Stainless steel lugs  
 Hardware : Stainless steel  
 Gaskets : Silicon  
 Lampholder : Polycarbonate G13 or G5 caps  
 Cable entry : EVF : N° 3 ø3/4" - EVFC : N° 2 ø3/4"

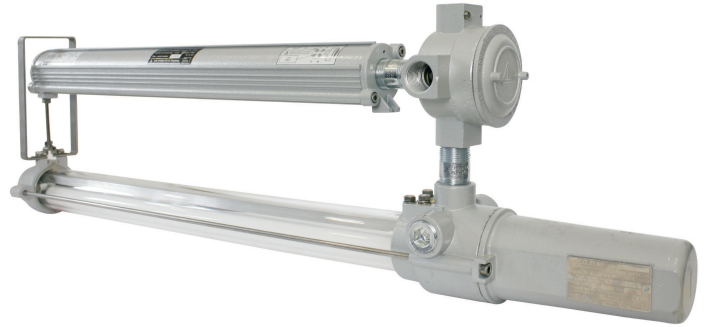

Tensione : 230 [Vac]  
 24..110 [Vac/dc] vedi P8: EVF con LED  
 Fattore di potenza : >0.9 con reattore elettronico  
 Accessori : tubo fluorescente : suffisso (L)  
 (a richiesta) Riflettore : suffisso (D)  
 Gabbia : suffisso (P)  
 Condensatore : suffisso (C)  
 Batteria : Ni-Cd 3,6V 4Ah, a richiesta 7Ah  
 Backup 18W(120') 36W(90') 58W (60')  
 Voltage : 230 [Vac] on demand [110Vac/dc]  
 24..110 [Vac/dc] see P8: EVF with LED  
 Power factor : >0.9 with electronic ballast  
 Accessories : fluorescente tube : suffix (L)  
 (on demand) Reflector : suffix (D)  
 Guard : suffix (P)  
 Capacitor : suffix (C)  
 Batteria : Ni-Cd 3,6V 4Ah, on demand 7Ah  
 Backup 18W(120') 36W(90') 58W (60')

Codice / Code	A	B	C	[W]	weight [kg]
EVFE.. 118..	610	205	573	1 x 4+20	
EVFE.. 218..	610	205	573	2 x 4+20	
EVFE.. 136..	1210	205	1173	1 x 32+54	
EVFE.. 236..	1210	205	1173	2 x 32+54	
EVFE.. 158..	1510	260	1473	1 x 51+65	
EVFE.. 258..	1510	260	1473	2 x 51+65	

Funzionamento solo emergenza / Only emergency function

Codice / Code	A	B	C	[W]	weight [kg]
EVFE.. 118..	610	205	573	1 x 4+20	
EVFE.. 136..	1210	205	1173	1 x 32+54	
EVFE.. 158..	1510	260	1473	1 x 51+65	



Reattore induttivo  
Inductive ballast

Codice / Code	A	B	C	G13	[W]	weight [kg]
EVFE.. 118R	610	205	573	G13	1x16+18	
EVFE.. 218R	610	205	573	G13	2x16+18	
EVFE.. 136R	1210	205	1173	G13	1x32+36	
EVFE.. 236R	1210	205	1173	G13	2x32+32	
EVFE.. 158R	1510	260	1473	G13	1x51+58	
EVFE.. 258R	1510	260	1473	G13	2x51+58	



Reattore elettronico  
Electronic ballast

Codice / Code	A	B	C	G13	[W]	weight [kg]
EVFE.. 118X	610	205	573	G13	1x16+18	
EVFE.. 218XX	610	205	573	G13	2x16+18	
EVFE.. 136X	1210	205	1173	G13	1x32+36	
EVFE.. 236XX	1210	205	1173	G13	2x32+32	
EVFE.. 158X	1510	260	1473	G13	1x51+58	
EVFE.. 258XX	1510	260	1473	G13	2x51+58	



Reattore elettronico sigillato  
Sealed electronic ballast

Codice / Code	A	B	C	-	[W]	weight [kg]
EVFE.. 118W	610	205	573	-	1x16+18	
EVFE.. 218W	610	205	573	-	2x16+18	
EVFE.. 136W	1210	205	1173	-	1x32+36	
EVFE.. 236W	1210	205	1173	-	2x32+32	
EVFE.. 158W	1510	260	1473	-	1x51+58	
EVFE.. 258W	1510	260	1473	-	2x51+58	



Reattore elettronico  
Electronic ballast

Codice / Code	A	B	C	G5	[W]	weight [kg]
EVFE.. 116X	610	420	573	G5	1x14+24	
EVFE.. 216XX	610	420	573	G5	2x14+24	
EVFE.. 128X	1210	420	1173	G5	1x28+54	
EVFE.. 228XX	1210	420	1173	G5	2x28+54	
EVFE.. 135X	1510	420	1473	G5	1x35+80	
EVFE.. 235XX	1510	420	1473	G5	2x35+80	

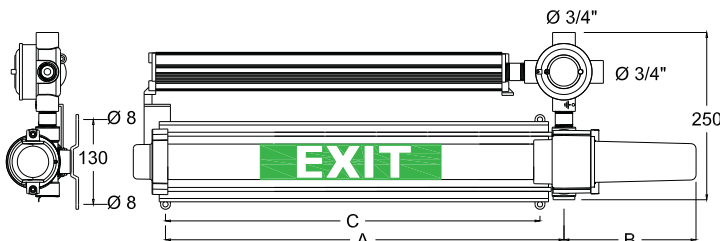

Sezionatore batterie  
Battery switch



Alimentazione Linea - Linea pilota  
Line - Pilot line power supply



**P11**



GAS	II2G Ex d IIC T6 ÷ T4	<b>Gb</b>	IP66/67	Zone 1 - Zone 2 Zone 21 - Zone 22
GAS	II2D Ex tb IIC T80÷T130°C	<b>Db</b>	IP66/67	❄️ -20°C ÷ ☀️ +40°C      ❄️ -20°C + ☀️ +60°C

EVFE.. Sospensione - Pendant

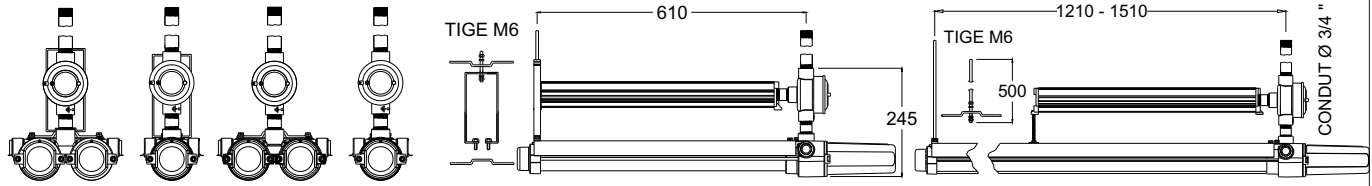

EVFE.C Soffitto - Ceiling

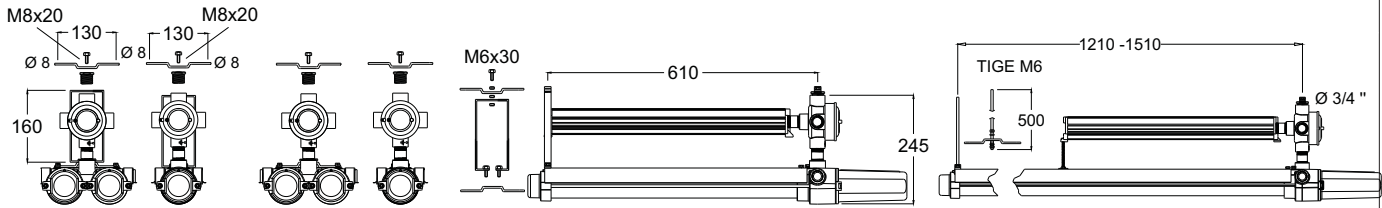

EVFE.J Parete (Alimentazione dal basso) - Wall mounting

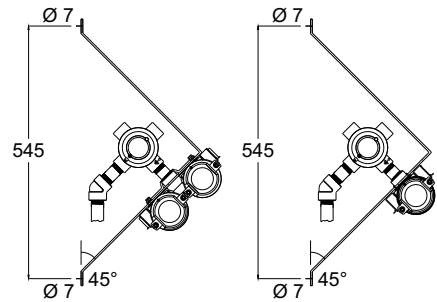

EVFE.J Parete (Alimentazione dall'alto) - Wall mounting

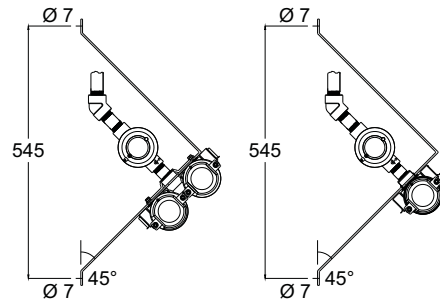

EVFE.P Palina - Pole mounting

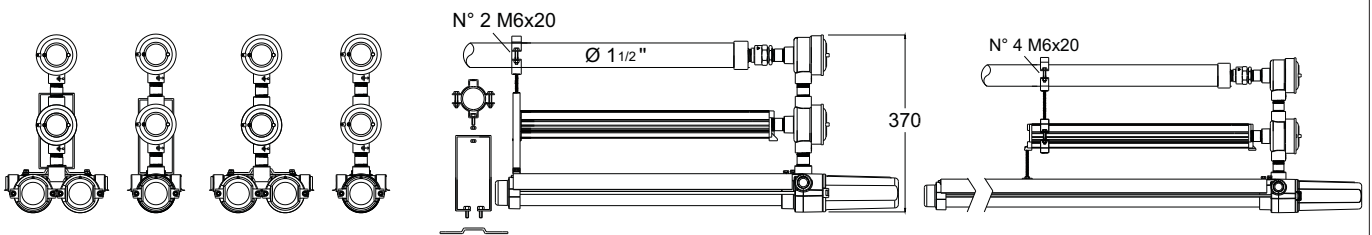

EVFE.CP Palina (ingresso con pressacavo) - Pole mounting (cable entry with cable gland)

